

John Faree

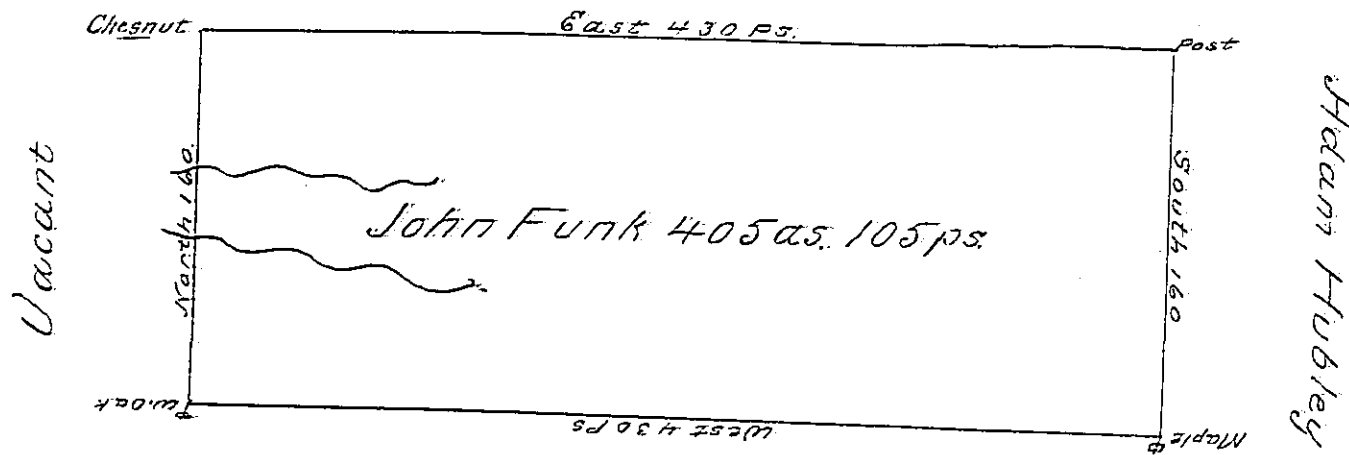

John Breckbell

Situated on the waters of Towlick Creek in  
 Wheatfield Township Westmoreland County, contg. 405  
 acres & 105 perches & allowance of Six pcent for Road 80.  
 surveyed for John Funk the 25th. day of Novemr. 1794  
 on Warrant dated the 3d. day of May 1793

Daniel Broadhead Esq. S. J. James Ross U.S.

IN TESTIMONY that the above is a copy of the original remaining on file in  
 the Department of Internal Affairs of Pennsylvania, made  
 conformably to an Act of Assembly approved the 16th day of  
 February, 1833, I have hereunto set my Hand and caused  
 the Seal of said Department to be affixed at Harrisburg,  
 this fourth day of September 1900

*James Patton*  
 Secretary of Internal Affairs.